



## EM-TRAK – COMMITTED TO VESSEL SAFETY & SECURITY

With over twenty five years of product design and engineering heritage our products offer the very best in quality engineering, reliability, usability and operational performance. To achieve this unique mixture of quality and performance we develop and deploy the most advanced core technologies coupled with proven professional standard product design.

## EM-TRAK WARRANTY & SUPPORT

Em-trak is committed to providing the highest level of customer service. Our comprehensive global warranty ensures that in the unlikely event of a problem it will be resolved to your full satisfaction in the shortest possible time.

Further information about our warranty programme and instant advice and support for all our products can be obtained from our web site [www.em-trak.com](http://www.em-trak.com) or your local authorised em-trak dealer.

The em-trak B100 is an aid to navigation and must not be relied upon to provide accurate navigation information. AIS is not a replacement for vigilant human lookouts and other navigation aids such as Radar. The performance of the B100 may be seriously impaired if not installed as instructed in the user manual, or due to other factors such as weather and or nearby transmitting devices. Compatibility with other systems may vary and is reliant on the third party systems recognising the standard outputs from the B100. em-trak reserves the right to update and change these specifications at any time and without notice.

### Head Office:

em-trak Marine Electronics Ltd  
Wireless House  
Westfield Industrial Estate  
Midsomer Norton  
Bath BA3 4BS  
United Kingdom

T +44 (0)1761 409 559  
F +44 (0)1761 410 093  
E [enquiries@em-trak.com](mailto:enquiries@em-trak.com)  
W [www.em-trak.com](http://www.em-trak.com)

### USA Office:

em-trak Marine Electronics Ltd  
470 Atlantic Avenue  
4th floor  
Boston  
02210  
USA

T +1 617 273 8395  
F +1 617 273 8001  
E [enquiries@em-trak.com](mailto:enquiries@em-trak.com)  
W [www.em-trak.com](http://www.em-trak.com)

## EM-TRAK B100 FEATURES & SPECIFICATION

### DIMENSIONS & WEIGHT

- > 115mm x 37mm x 116mm (W x H x D)
- > 150 g (AIS transceiver unit only)

### DATA INTERFACES

- > USB
- > NMEA2000
- > NMEA0183 38.4k baud bi-directional
- > NMEA0183 4.8k baud bi-directional interface for data multiplex

### POWER

- > 12 or 24 V DC (max 9.6-31.2V)
- > Average power consumption 2W

### CERTIFICATION

- > CE marking under RED for Europe
- > FCC
- > Industry Canada
- > USCG

## WHAT'S IN THE BOX

Class B AIS Transceiver

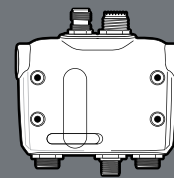

GPS Antenna

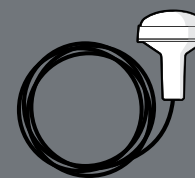

Power and Data Cable



USB Cable



Product Manual

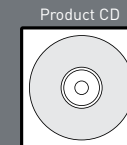

Product CD

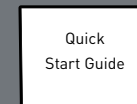

Quick Start Guide

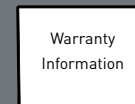

Warranty Information

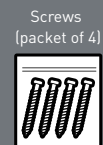

Screws (packet of 4)



PROFESSIONAL STANDARD RELIABILITY

Product Code: 411-0001

# B100

AIS CLASS B





THE AIS CLASS B100 IS A SMALL, FULL FEATURE, INTERNATIONALLY CERTIFIED AIS CLASS B TRANSCIVER IDEAL FOR LEISURE AND SMALL COMMERCIAL VESSELS.



PRODUCT HIGHLIGHTS

- > Global Certification
- > Small, easy to install & use
- > SD card VDR system
- > Plug & play connectivity with existing systems
- > Low power consumption

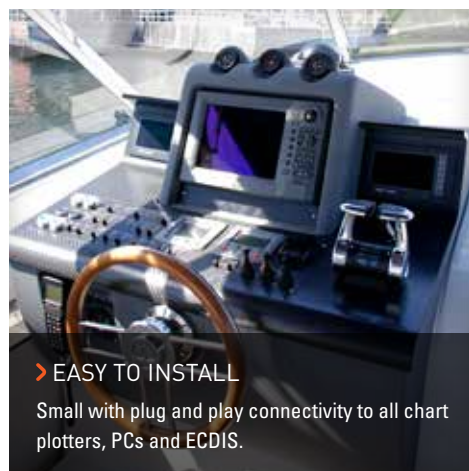

> EASY TO INSTALL

Small with plug and play connectivity to all chart plotters, PCs and ECDIS.



> MULTIPLE INTERFACES

Dual NMEA 0183 and NMEA 2000 intelligent data interfaces.



> LOW POWER CONSUMPTION

Lowest power consumption of any Class B.



> ENHANCED PERFORMANCE

Advanced HF-AIS™ technology guarantees superior receive and transmit performance.

## > KEY FEATURES

The em-trak B100 provides you with a high performance, easy to install and use AIS Class B transceiver suitable for any small commercial or leisure vessel.

After fifteen years of creating marine electronics products we understand the environment within which our products must operate. The B100 is a single small unit which is simple to install and use and has been specifically designed, engineered and manufactured for long term continuous use in even the most extreme marine environments.

The B100's core technology enables it with superior radio performance which translates into you always seeing all targets and maximum range. The B100 offers the ideal combination of quality, performance and price.

- > HF-AIS™ core technology
- > Fully certified – EU, US, Global
- > Small, robust unit
- > Plug & play connectivity with other systems
- > SD CARD Data logging
- > Low power consumption
- > Silent mode
- > Ruggedised, vibration resistant
- > MOB & SART detection
- > Multi-lingual manuals
- > Easy programming tool
- > Built in fault check & fix system
- > Enhanced operating performance

## > CONFIGURATION OPTIONS

The functionality of the B100 can be enhanced to meet a wide range of specific user and regional requirements. This includes the implementation of security features such as encryption, special input functionality, SAT-Trak enhanced satellite message detection technology, and variable transmit power.

Please contact us with your specific requirements for a quote.

## > FEATURE HIGHLIGHTS

### MULTIPLE INTERFACES



Dual NMEA 0183 and 2000 data interfaces.

### SD CARD DATA LOGGING



The SD card slot enables you to record every trip and download on your PC to view and share with friends and family.

### THE EM-TRAK RANGE

